

OCEAN CITY'S "INDUCTOR" REELS NOS. 249, 250 AND 251  
(Model B)

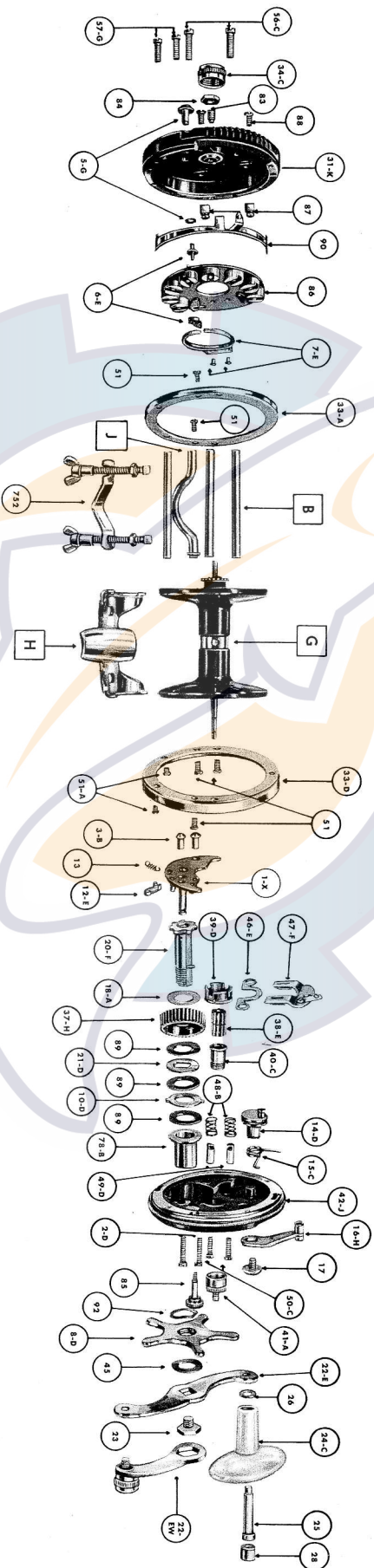

HOW TO ORDER PARTS FOR YOUR REEL—locate the part desired in the illustration above and note part number, part name and model letter which you will find on underside of reel stand. Enclose money order, stamps or check. Our minimum charge for one order is \$2.25; please add \$.15 on each order for return postage and insurance.

PART No.	PART NAME	PRICE	PART No.	PART NAME	PRICE	PART No.	PART NAME	PRICE	PART No.	PART NAME	PRICE
1-X	Bridge	.30	16-H	Free Spool Lever	.05	23	Handle Screw	.16	41-A	Right Side Adjusting Cap	.12
2-D	Bridge Screw Nut	.02	17	Frame Post (for No. 250 only)	.12	31-K	Left Side Plate Complete with Part No. 5-6	1.50	44-2B	Spool (for Mode No. 249 only)	2.50
3-B	Click Button and Washer	.12	19-F	Frame Post (for No. 251 only)	.14	33-A	Left Side Plate Ring	.32	44-2C	Spool (for Mode No. 250 only)	2.75
4-E	Click Pawl and Rivet	.08	19-G	Frame Post (for No. 249 only)	.12	34-C	Left Side Adjusting Screw	.12	43-N	Stand (for Mode No. 250 only)	3.00
7-E	Click Spring and Rivets	.14	77-D	Frame Post (for No. 250 only)	.20	83	Left Side Oil Cap	.12	43-O	Stand (for Mode No. 251 only)	1.00
90	Gear Assembly	.30	77-E	Frame Post Thumb Bar (for Model No. 251 only)	.20	84	Left Side Adjusting Nut	.02	43-P	Stand (for Mode No. 249 only)	.60
12-E	Drag Dog Spring	.10	20-F	Gear Sleeve and Lock Pin (for Model No. 250 only)	.20	86	Main Gear	.90	56-C	Screw, Left Side Plate	.02
13	Drag Dog	.03	78-B	Gear Sleeve Bushing	.60	37-H	Magnetic Bridge	3.25	57-G	Screw, Right and Left Inner Post	.02
18-A	Drag Fiber Washer	.01	22-E	Handle Wrench only	.25	88	Magnetic Bridge Stud	.06	51-A	Screw, Right Side Inner Stand	.02
89	Drag Laminated Washer	.02	22-F	24-C, 25, 28, and 22-EW	1.00	38-E	Pinion Gear	.30	47-F	Yoke Plate	.30
21-D	Drag Faced Washer	.05	22-GW	Handle Wrench only	.30	39-D	Right Side Plate Complete with Part No. 85	1.25	48-B	Yoke Spring	.04
10-D	Drag Star Bottom Washer	.04	24-C	Handle Knob Rivet	.24	42-J	Right Side Plate Lock Screw	.50	49-D	Yoke Guide Stud	.06
45	Drag Star Top Washer	.32	25	Handle Knob Rivet	.01	85	Right Side Frame Ring	.25	50-C	Bar Type Reel Clamp (for Nos. 250 and 251 only)	.02
8-D	Drag Star	.50	28	Handle Knob Oiler	.24	40-C	Right Side Bearing Only	.20	752		.75
14-D	Eccentric	.12									
15-C	Eccentric Spring	.12									